



FRONT HUB (CenterLock)

QR Configuration

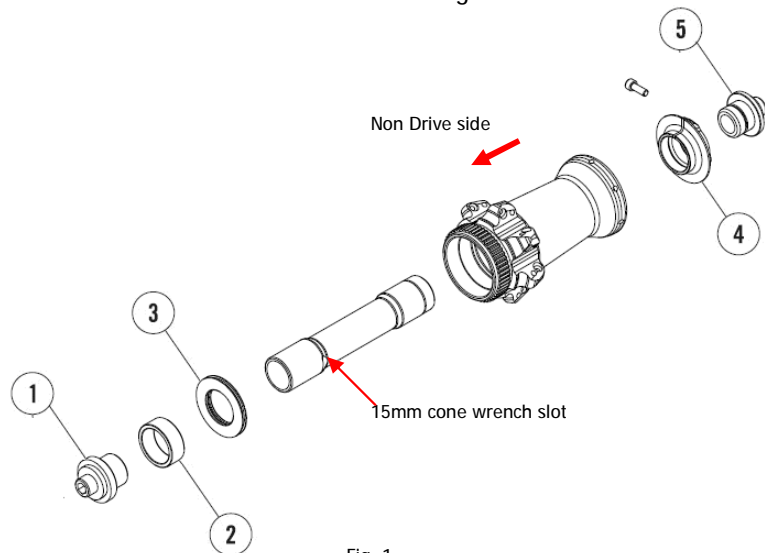

Fig. 1

TA Configuration

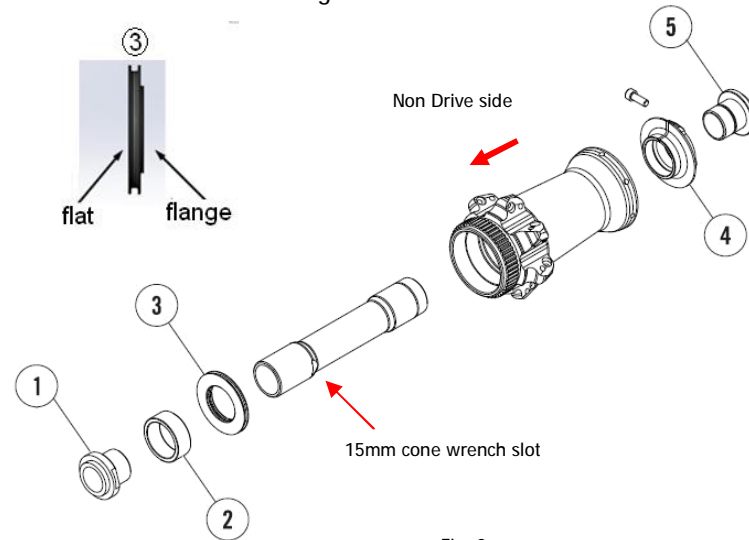

Fig. 2

Tools required

- 17mm Cone Wrench
- 15mm Cone Wrench

Components

- ① MW524 Front Hub Threaded End Caps (DS) - QR
- ② MW523 Front hub Spacer 7.8mm (NDS)
- ③ MW522 Bearings Shield
- ④ MW578 PRA Adjustment Collar (DS)
- ⑤ MW525 Front Hub Threadless End Caps (NDS) - QR

QR Configuration Removal

1. Loosen the M3 PRA adjust collar set screw in the PRA adjustment collar ④ using a 2.5mm Allen Key.
2. Push to remove QR End cap (NDS) ⑤
3. Unscrew the PRA collar ④ to push QR end cap (NDS) ①
4. Pull Axle (include ①②③) out of hub shell, and taking note of which direction they face. (Fig.1)
5. Remove ②③
6. Use a 5mm Allen Key in QR end cap (DS) ① and 15mm cone wrench on the axle to remove QR end cap.

Note: Front hub 6-Bolt Version and CenterLock Version use the same end cap kit.

- 5mm Allen Key
- 2.5mm Allen Key

- ① MW580 Front Hub Threaded End Caps (DS) – TA
- ② MW523 Front hub Spacer 7.8mm (NDS)
- ③ MW522 Bearings Shield
- ④ MW578 PRA Adjustment Collar (DS)
- ⑤ MW581 Front Hub Threadless End Caps (NDS) – TA

TA Configuration Installation

1. Install TA end cap ① to axle by using 15mm and 17mm cone wrench.
2. Insert ② onto axle.
3. Insert ③ onto axle with flat face toward Spacer ②, flange face to hub. (Fig.2)
4. Insert axle to hub shell from non-drive side.
5. Install PRA adjustment collar ④. For adjustment see wheelset installation instruction.
6. Press TA end cap ⑤ onto axle.
7. Tighten the M3 PRA adjust collar set screw in the PRA adjustment collar ④ using a 2.5mm Allen Key.

REAR HUB (CenterLock)

QR Configuration

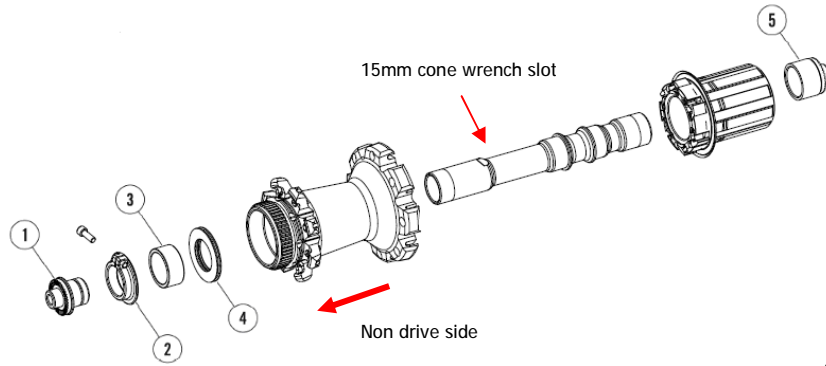

TA Configuration

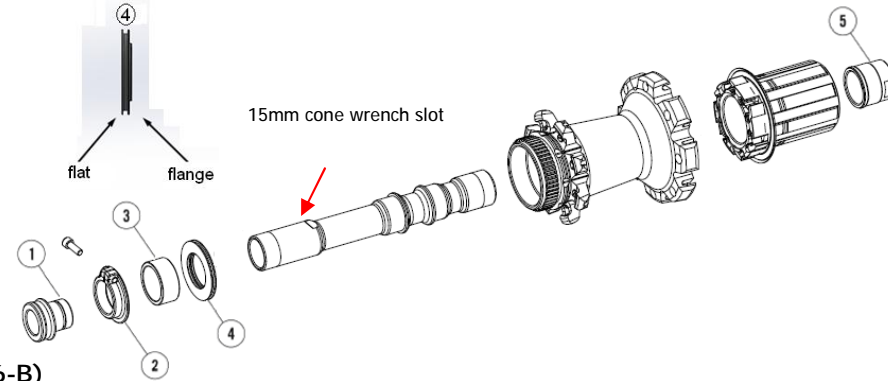

REAR HUB (6-B)

QR Configuration

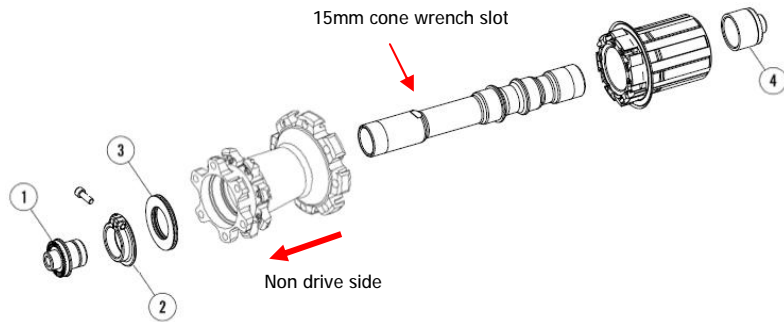

TA Configuration

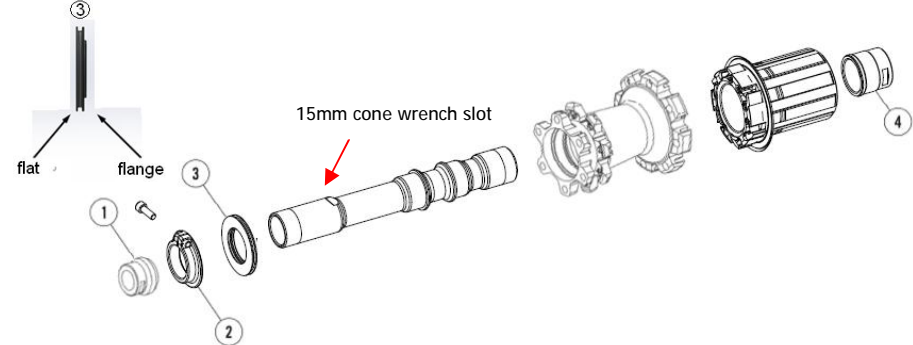

Components

CenterLock Version

- ① MW525 Rear Hub End Caps (NDS) - QR
- ② MW537 PRA Adjustment Collar
- ③ MW539 Rear Hub Spacer 9.2mm
- ④ MS522 Bearings Shield
- ⑤ MW405 Rear Hub End Caps (DS) - QR
- ① MW535 Rear Hub End Caps (NDS) – TA (X12)
- ② MW537 PRA Adjustment Collar
- ③ MW539 Rear Hub Spacer 9.2mm
- ④ MS522 Bearings Shield
- ⑤ MW536 Rear Hub End Caps (DS) – TA (X12)

6-B Version

- ① MW406 Rear Hub End Caps (NDS) - QR
- ② MW560 PRA Adjustment Collar
- ③ MS334 Bearings Shield
- ④ MW405 Rear Hub End Caps (DS) - QR
- ① MW404 Rear Hub End Caps (NDS) - TA (X12)
- ② MW560 PRA Adjustment Collar
- ③ MS334 Bearings Shield
- ④ MW536 Rear Hub End Caps (DS) – TA (X12)

QR Configuration Removal

1. Loosen the M3 PRA adjust collar set screw in the PRA adjustment collar ② using a 2.5mm Allen Key.
2. Unscrew and use PRA collar to extract QR end cap (NDS) ①
3. Remove PRA adjustment collar ②
4. Remove Bearings Shield & Spacer (6-B Version no Spacer) from non drive side.
5. Remove freehub and axle from drive side.
6. Remove QR end cap (DS) with a 15mm cone wrench on the axle and a 5mm Allen key for QR end cap.

TA Configuration Installation

1. Install Freehub onto axle.
2. Install TA end Cap ① (DS) to axle by using 15mm and 17mm cone wrench.
3. Install axle with freehub into hub shell.
4. Insert bearing shield (and spacer for Centerlock version) onto axle with flat face against PRA Adjustment Collar.
5. Install PRA adjustment collar by threading onto axle.
6. Press endcap (NDS) onto axle
7. Tighten the M3 PRA adjust collar set screw in the PRA adjustment collar using a 2.5mm Allen Key.