



FRONT HUB (CenterLock)

QR Configuration

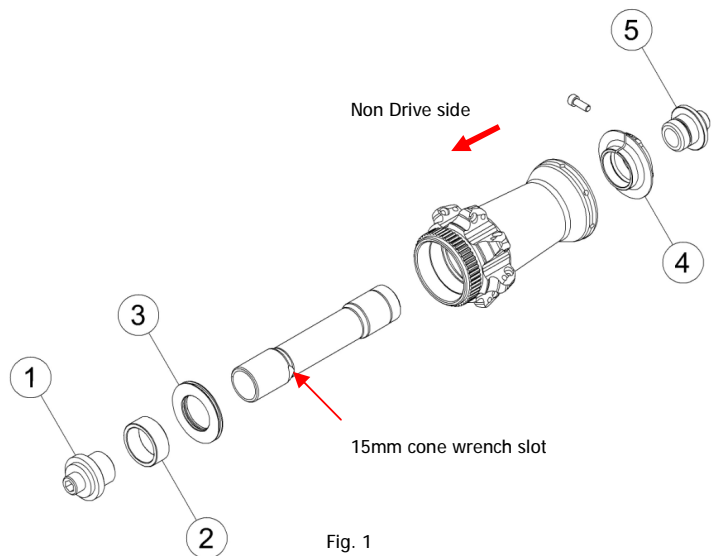

Fig. 1

TA Configuration

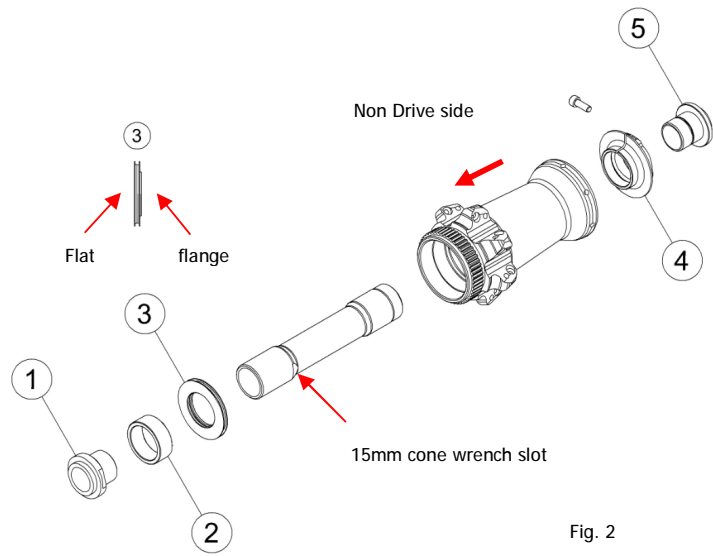

Fig. 2

Tools required

- 17mm Cone Wrench
- 15mm Cone Wrench

Components

- ① MW524 Front Hub Threaded End Caps (DS) - QR
- ② MW523 Front hub Spacer 7.8mm (NDS)
- ③ MW522 Bearings Shield
- ④ MW578 PRA Adjustment Collar (DS)
- ⑤ MW525 Front Hub Threadless End Caps (NDS) - QR

QR Configuration Removal

1. Loosen the M3 PRA adjust collar set screw in the PRA adjustment collar ④ using a 2.5mm Allen Key.
2. Push to remove QR End cap (NDS) ⑤.
3. Unscrew the PRA collar ④ to push QR end cap (NDS) ⑤.
4. Pull Axle (include ① · ② · ③) out of hub shell, and taking note of which direction they face. (Fig.1) .
5. Remove ② · ③.
6. Use a 5mm Allen Key in QR end cap (DS) ① and 15mm cone wrench on the axle to remove QR end cap.

Note: Front hub 6-Bolt Version and CenterLock Version use the same end cap kit.

- 5mm Allen Key
- 2.5mm Allen Key

- ① MW580 Front Hub Threaded End Caps (DS) – TA
- ② MW523 Front hub Spacer 7.8mm (NDS)
- ③ MW522 Bearings Shield
- ④ MW578 PRA Adjustment Collar (DS)
- ⑤ MW581 Front Hub Threadless End Caps (NDS) – TA

TA Configuration Installation

1. Install TA end cap ① to axle by using 15mm and 17mm cone wrench.
2. Insert ② onto axle.
3. Insert ③ onto axle with flat face toward Spacer ②, flange face to hub. (Fig.2) .
4. Insert axle to hub shell from non-drive side.
5. Install PRA adjustment collar ④. For adjustment see wheelset installation instruction.
6. Press TA end cap ⑤ onto axle.
7. Tighten the M3 PRA adjust collar set screw in the PRA adjustment collar ④ using a 2.5mm Allen Key.

REAR HUB (CenterLock)

QR Configuration

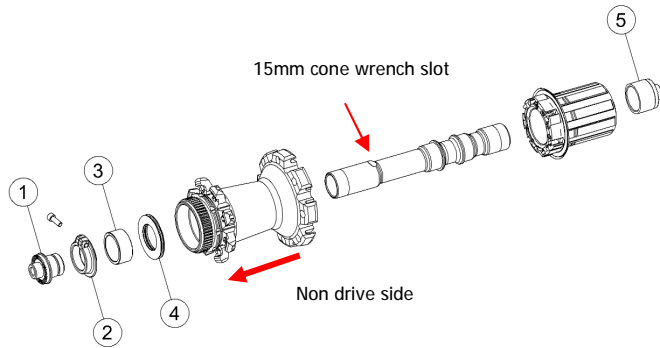

TA Configuration

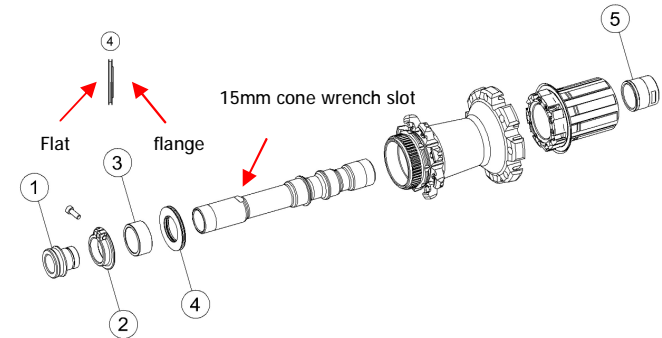

REAR HUB (6-B)

QR Configuration

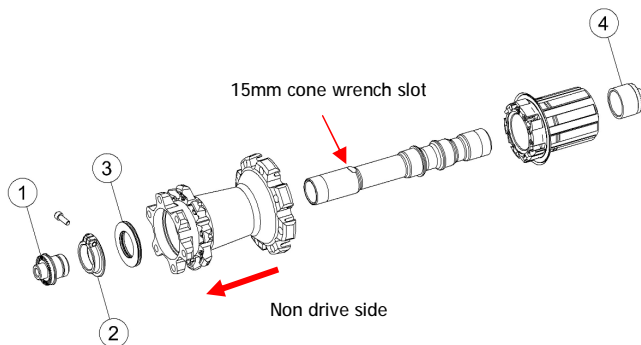

TA Configuration

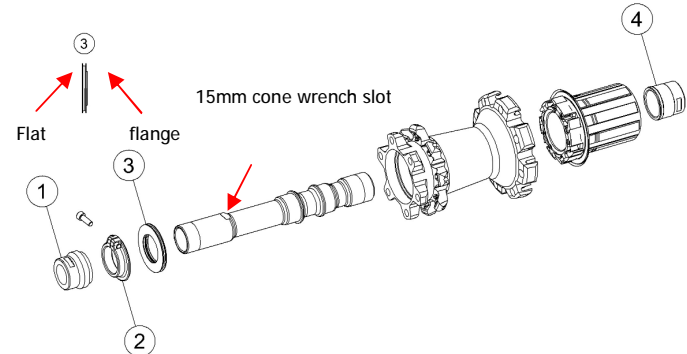

Components

CenterLock Version

- | | |
|--------------------------------------|--|
| ① MW525 Rear Hub End Caps (NDS) - QR | ① MW535 Rear Hub End Caps (NDS) - TA (X12) |
| ② MW537 PRA Adjustment Collar | ② MW537 PRA Adjustment Collar |
| ③ MW539 Rear Hub Spacer 9.2mm | ③ MW539 Rear Hub Spacer 9.2mm |
| ④ MW522 Bearings Shield | ④ MS522 Bearings Shield |
| ⑤ MW405 Rear Hub End Caps (DS) - QR | ⑤ MW536 Rear Hub End Caps (DS) - TA (X12) |

6-B Version

- | | |
|--------------------------------------|--|
| ① MW406 Rear Hub End Caps (NDS) - QR | ① MW404 Rear Hub End Caps (NDS) - TA (X12) |
| ② MW560 PRA Adjustment Collar | ② MW560 PRA Adjustment Collar |
| ③ MS334 Bearings Shield | ③ MS334 Bearings Shield |
| ④ MW405 Rear Hub End Caps (DS) - QR | ④ MW536 Rear Hub End Caps (DS) - TA (X12) |

QR Configuration Removal

- Loosen the M3 PRA adjust collar set screw in the PRA adjustment collar ② using a 2.5mm Allen Key.
- Unscrew and use PRA collar to extract QR end cap (NDS) ①.
- Remove PRA adjustment collar ②.
- Remove Bearings Shield & Spacer (6-B Version no Spacer) from non drive side.
- Remove freehub and axle from drive side.
- Remove QR end cap (DS) with a 15mm cone wrench on the axle and a 5mm Allen key for QR end cap.

TA Configuration Installation

- Install Freehub onto axle.
- Install TA end Cap ① (DS) to axle by using 15mm and 17mm cone wrench.
- Install axle with freehub into hub shell.
- Insert bearing shield (and spacer for Centerlock version) onto axle with flat face against PRA Adjustment Collar.
- Install PRA adjustment collar by threading onto axle.
- Press endcap (NDS) onto axle.
- Tighten the M3 PRA adjust collar set screw in the PRA adjustment collar using a 2.5mm Allen Key.

Contact

If you have questions, please visit our web site technical section: <http://www.fullspeedahead.com/contact> or contact:

Full Speed Ahead, USA
12212 Cyrus Way Mukilteo, WA 98275-5702
Tel: 1-425-488-8653 Fax: 1-425-489-1092

Full Speed Ahead, Europe
Via Del Lavoro, 56 20874 Busnago, Milan, Italy
Tel: +39-039-688-9265 Fax: +39-039-662-3336

TH INDUSTRIES / FSA Asia
NO.6, Wu-gang 8th Rd., Wu-feng Dist., Taichung City 41353, Taiwan (R.O.C.)
Tel: +886-4-2331-9134 Fax: +886-4-2331-9314

Notes: Specifications of product may be changed or improved for performance. Please refer to website periodically for technical updates and revised instructions. Printed in Taiwan.