

## Road Disc Brake Wheelset Installation Instructions

Published – Sep, 2022. ZS201.v4 © Full Speed Ahead

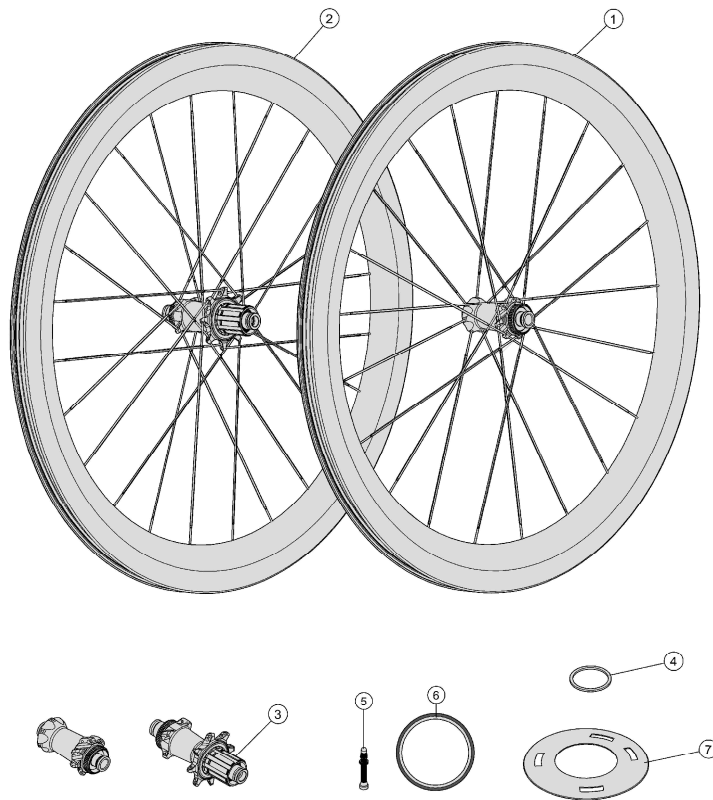

### Components

Follow the assembly order in the illustration:

- ① Front Wheel
- ② Rear Wheel
- ③ Freehub Body
- ④ 9s / 10s Conversion Spacer
- ⑤ Tubeless Valve
- ⑥ Tubeless Rim Tape
- ⑦ Wheelset Spoke Protector

### Introduction

Congratulations on the purchase of this superior Vision product! Please read these instructions and follow them for correct use. Failure to follow the warnings and instructions could result in damage to product not covered under warranty, damage to your bicycle; or cause an accident resulting in injury or death. Since specific tools and experience are necessary for proper installation, it is recommended that the product be installed by a qualified bicycle technician. Full Speed Ahead & Vision assumes no responsibility for damages or injury related to improperly installed components.

### Warranty

Full Speed Ahead (FSA) warrants all FSA and Vision products to be free from defects in materials or workmanship for a period of two years after original purchase unless otherwise stated in the full warranty policy. The warranty is non-transferable and valid to the original purchaser of the product only. Any attempt to modify the product in any way such as drilling, grinding, and painting will void the warranty. For more information on warranty policy and instructions for completing a warranty claim, check out the Full Warranty Policy found at our website: <https://www.visiontechusa.com/en/technology>

### Specification

#### Vision Wheelsets Spoke Tension Chart

Model Name	Item Number	Rim size	Spokes Lengths x Number			
			Front( DS)	Front( NDS)	Rear (DS)	Rear (NDS)
Metron 81 Tubular Disc Centerlock	WH-VT-880TU/DB-CL	633	228mmx7	243mmx14	243mmx16	243mmx8
Metron 81 Clincher Disc Centerlock	WH-VT-880CHTL/DB-CL	700C	229mmx7	243mmx14	245mmx16	243mmx8
Metron 60 Tubular Disc Centerlock	WH-VT-860TU/DB-CL	633	248mmx7	262mmx14	262mmx16	261mmx8
Metron 60 Clincher Disc Centerlock	WH-VT-860CHTL/DB-CL	700C	248mmx7	262mmx14	262mmx16	261mmx8
Metron 45 Tubular Disc Centerlock	WH-VT-845TU/DB-CL	633	263mmx7	277mmx14	277mmx16	276mmx8
Metron 45 Clincher Disc Centerlock	WH-VT-845CHTL/DB-CL	700C	263mmx7	277mmx14	277mmx16	276mmx8
Metron 30 Tubular Disc Centerlock	WH-VT-832TU/DB-CL	633	279mmx7	291mmx14	291mmx16	291mmx8
Metron 30 Clincher Disc Centerlock	WH-VT-832CHTL/DB-CL	700C	279mmx7	291mmx14	291mmx16	291mmx8
Vision NS SC55 Clincher Disc Centerlock	WH-VT-654CHTL/DB-CL	700C	259mmx8	264mmx16	274mmx16	252mmx8
Vision NS TC40 Clincher Disc Centerlock	WH-VT-642CHTL/DB-CL	700C	259mmx8	264mmx16	274mmx16	252mmx8
Vision NS SC40 Clincher Disc Centerlock	WH-VT-641CHTL/DB-CL	700C	269mmx8	282mmx16	282mmx16	279mmx8
TriMax TC35 Clincher Disc Centerlock	WH-VT-639CHTL/DB-CL	700C	265mmx8	276mmx16	276mmx16	258mmx8
TriMax 35 Clincher Disc Centerlock	WH-VT-638CHTL/DB-CL	700C	272mmx8	286mmx16	285mmx16	281mmx8
Vision NS TC30 Clincher Disc Centerlock	WH-VT-632CHTL/DB-CL	700C	269mmx8	274mmx16	284mmx16	262mmx8
Vision NS SC30 Clincher Disc Centerlock	WH-VT-631CHTL/DB-CL	700C	278mmx8	291mmx16	291mmx16	288mmx8
TriMax 25 Clincher Disc Centerlock	WH-VT-626CHTL/DB-CL	700C	284mmx8	301mmx16	296mmx16	292mmx8
TriMax TC30 Clincher Disc Centerlock	WH-VT-608CHTL/DB-CL	700C	270mmx8	281mmx16	281mmx16	263mmx8
TriMax 30 Clincher Disc Centerlock	WH-VT-606CHTL/DB-CL	700C	277mmx8	291mmx16	290mmx16	286mmx8
Team 35 Clincher Disc Centerlock	WH-VT-341CHTL/DB-CL	700C	264mmx8	284mmx16	283mmx16	262mmx8
Team 35 Clincher Disc ISO 6-Bolt	WH-VT-341CHTL/DB-CL	700C	264mmx8	284mmx16	283mmx16	262mmx8
Team TC35 Clincher Disc Centerlock	WH-VT-340CHTL/DB-CL	700C	265mmx8	276mmx16	276mmx16	258mmx8
Team TC30 Clincher Disc Centerlock	WH-VT-307CHTL/DB-CL	700C	270mmx8	281mmx16	281mmx16	263mmx8
Team 30 Clincher Disc Centerlock	WH-VT-306CHTL/DB-CL	700C	270mmx8	290mmx16	289mmx16	267mmx8
Team 30 Clincher Disc ISO 6-Bolt	WH-VT-306CHTL/DB-CL	700C	270mmx8	290mmx16	289mmx16	267mmx8

**▲ WARNING** Use only original Vision spare parts for service. Use of incorrect spoke types and lengths may cause failure of the wheel resulting in accident and injury.

## Wheelset Installation

**⚠ WARNING** Gluing and mounting tubular tires requires skill and experience. It is highly recommended to have the tires mounted by a trained professional. Improperly mounted tires can separate from the wheel while riding causing serious injury to the rider and damage to the wheels and bicycle. If you are not confident you possess the skills necessary to mount your tires, take the wheels and tires to a qualified bicycle mechanic.

1. Ensure tire is correct type (tubular or clincher) for wheel model. Install tire on rim as instructed by tire manufacturer.

Note: Vision Meron Wheelsets are included tubeless kit, follow the installation instruction below.

2. Ensure rim tape or Tubeless Rim Tape ⑥ is applied and the Tubeless Valve ⑤ is installed.

3. Lightly grease the Freehub Body ③. Install the cassette. Wheels equipped with a Shimano Freehub Body ③ are compatible with Shimano 11 spd cassettes. To work with Shimano or Sram 9 spd, and 10 spd cassettes, install the 9s / 10s Conversion Spacer ④ onto the Freehub Body ③.

4. Wheels equipped with the Campagnolo Freehub Body ③ are compatible with Campagnolo 9, 10 and 11 speed cassettes.

5. Install disc brake rotor as instructed by manufacturer and tighten to manufacturer's recommended torque. **⚠ WARNING** Periodically check disc rotor screws for correct torque. Improper tightening or loose rotor screws can cause the rider to lose control of the bike and may result in injury or death.

Note: If your bicycle uses a Thru Axle system, install wheels into front or rear drop-outs following manufacturer's instructions. **⚠ WARNING** Check Through Axle for tightness before every ride.

6. Vision Spoke Protector ⑦ is intended to prevent the chain from falling down in the spokes. Please install it on the rear wheel before riding.

**⚠ WARNING** Do not use disc-brake wheels with rim brakes under any circumstances.

**⚠ CAUTION** Periodically inspect the wheels for damage. Vision wheels should be serviced by a qualified bicycle mechanic.

## Tubeless Rim Tape Installation

1. Using a small piece of abrasive pad or emery cloth, rotate the wheel for one full rotation while scrubbing the rim bed cavity to remove any small burrs and any glaze on the anodized finish.

2. Using a clean rag and isopropyl alcohol, clean the rim bed of any dirt or oil then wipe the rim cavity with a dry rag. Ensure there is no lint or foreign matter collected at the spoke holes.

3. To start the application of the tubeless rim tape ⑥, locate the decal on the rim between two spoke holes. Center the tape in rim bed and press to adhere. Hold the tape at the starting point with one hand and pull the tape as tightly as possible with the other hand. The tape will make some popping sounds but will not stretch and break. Alternately lay the tape on the rim bed and press or burnish the tape firmly with your fingers.

4. Repeat the procedure in Step 3 until you have wrapped the rim two complete times.

5. Overlap the starting point by about 4 inches and cut the tape.

6. Rotate the wheel one full revolution, pressing firmly with your fingers on the tape to make sure it has conformed to the rim bed. Ensure no wrinkles in the tape.

7. Locate the valve hole and using a small knife or razor blade, carefully cut open the valve hole with a small "x." Trim the radius of the hole.

8. Install the Tubeless Valve ⑤ in to valve hole and secure firmly using the valve adapter and valve nut.

WWW.VISIONTECHUSA.COM

**Vision**

### Contact

If you have questions, please visit our web site technical section: <https://www.visiontechusa.com/en/support> or contact:

Full Speed Ahead, USA  
12212 Cyrus Way Mukilteo, WA 98275-5702  
Tel: 1\_425\_488\_8653 Fax: 1\_425\_489\_1082

Full Speed Ahead, Europe  
Via Del Lavoro, 56 20874 Busnago, Milan, Italy  
Tel: +39\_039\_688\_5265 Fax: +39\_039\_682\_3336

TH INDUSTRIES / FSA Asia  
NO.6, Wu-gong 8th Rd., Wufeng Dist., Taichung City 41353, Taiwan (R.O.C.)  
Tel: +886\_4\_2331\_9134 Fax: +886\_4\_2331\_9314

Notes: Specifications of product may be changed or improved for performance. Please refer to website periodically for technical updates and revised instructions. Printed in Taiwan.

**FSA**  
FULL SPEED AHEAD

**Vision**